

Curved terminal already installed

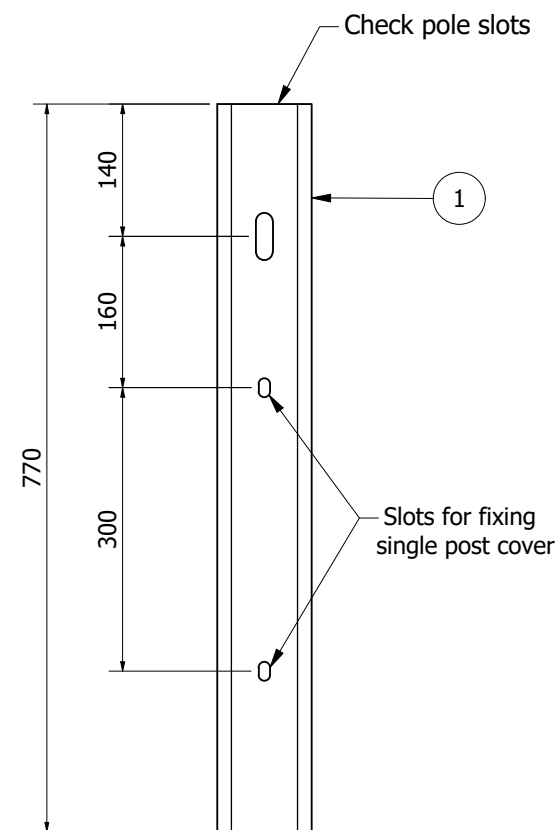

Step "A"
(Check the pile type)

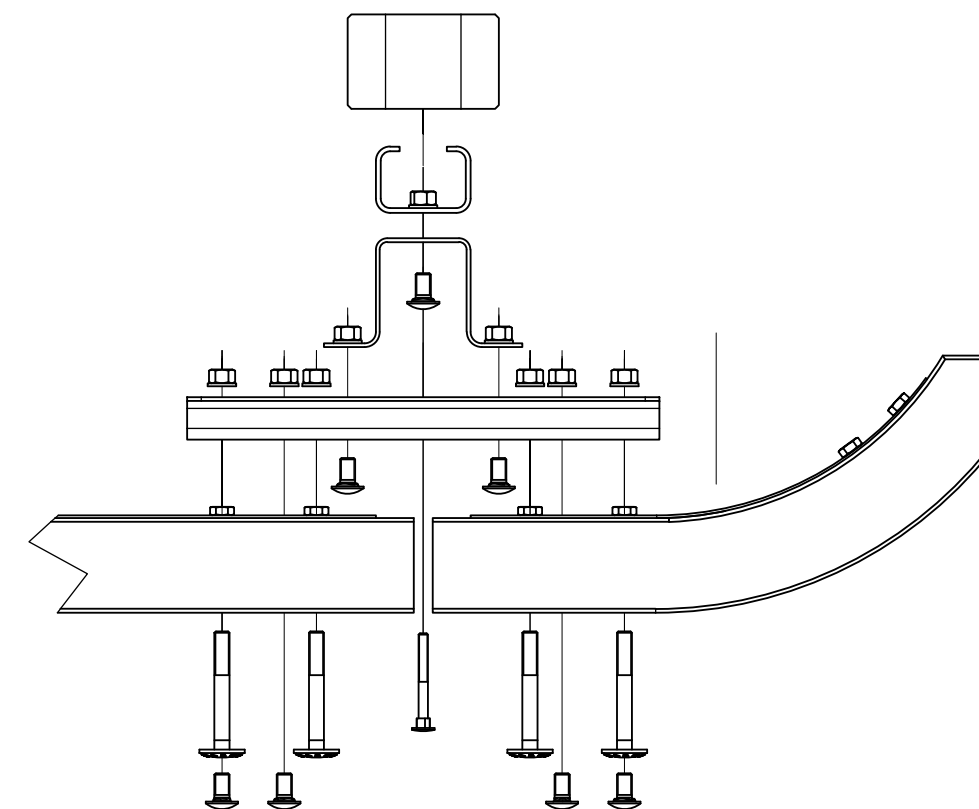

Step "B"
(disassembly of rail, curved terminal, splice plate and blockout)

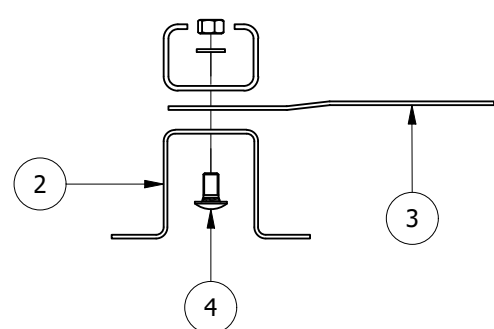

Step "C"
(Replacement of the blockout and assembly of the bracket)

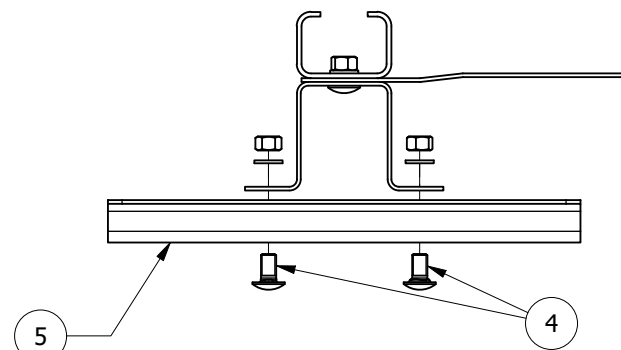

Step "D"
(Corrugated splice plate assembly)

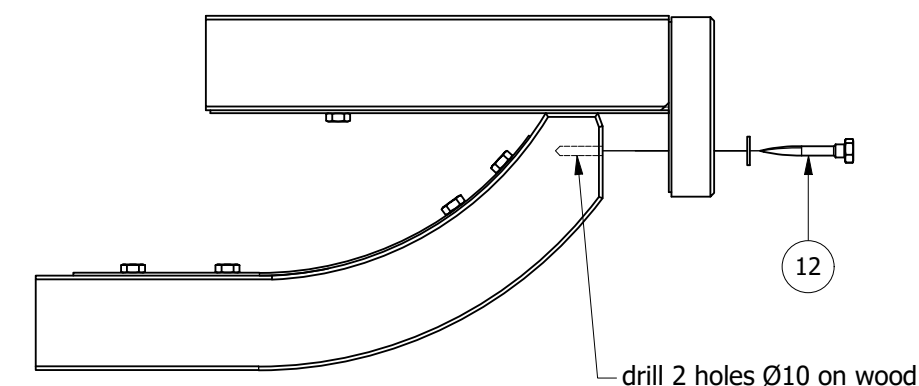
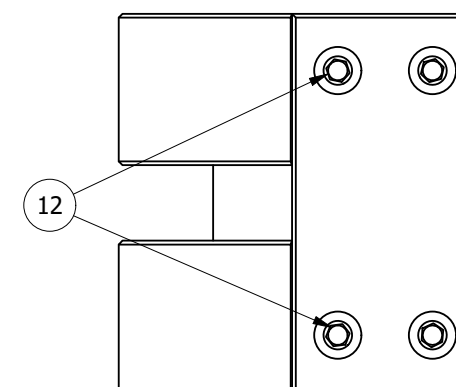
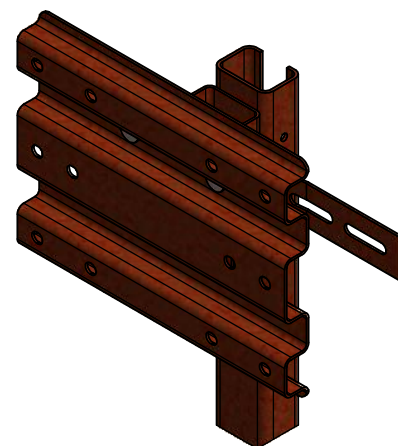
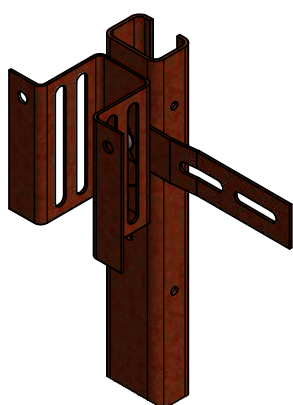

Step "E"
(assembly of the reinforcing T on the curved terminal)

Measurements expressed in mm

Tightening torque:

- Ref. 4 120 Nm
- Ref. 7 e 13 coppia compressa tra 150 e 200 Nm
- Ref. 9 serrare con dado e controdado

The torque values must be checked with a calibrated torque wrench
NB Carry out the indicated dimensions with extreme accuracy

Component list	
Ref.	Item
1	"C" post
2	Blockout
3	Bracket
4	Bolts TT M16x30
5	Corrugated Splice plate
6	Protection rail
7	Bolts TTQST M16x125
8	T50 Terminal
9	Bolts TT M16x35
10	Singl post cover
11	Bolts TTQST M10x100
12	Wood screw 14x60 & M16 washer
13	Bolts TT M16x30



MARGARITELLI
ROAD SAFETY

Drawing IM 034-02	Issued 19/12/2022
Review 00	Date --/--/----

Object: Energy absorbing terminal T50 class - T50-01
Tested for T50 Class in compliance with CEN/TS Terminals
Assembly instructions

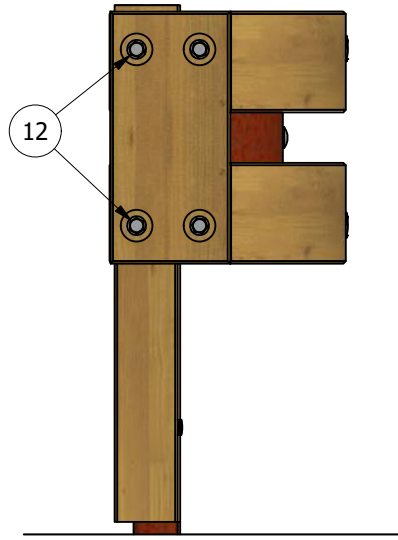
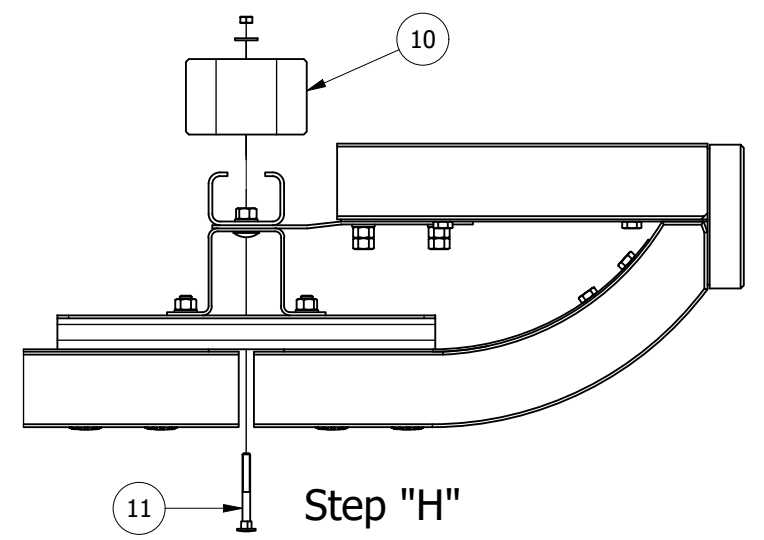
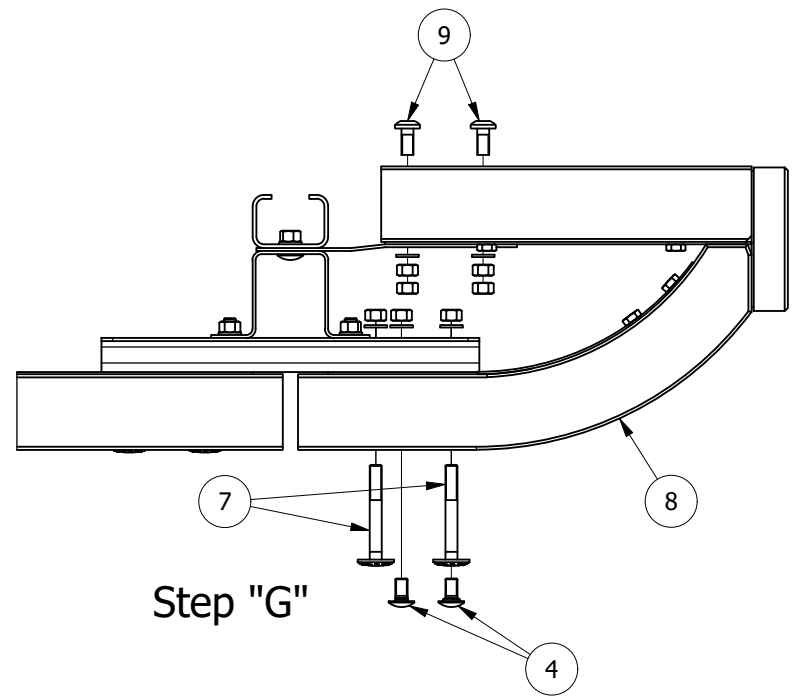
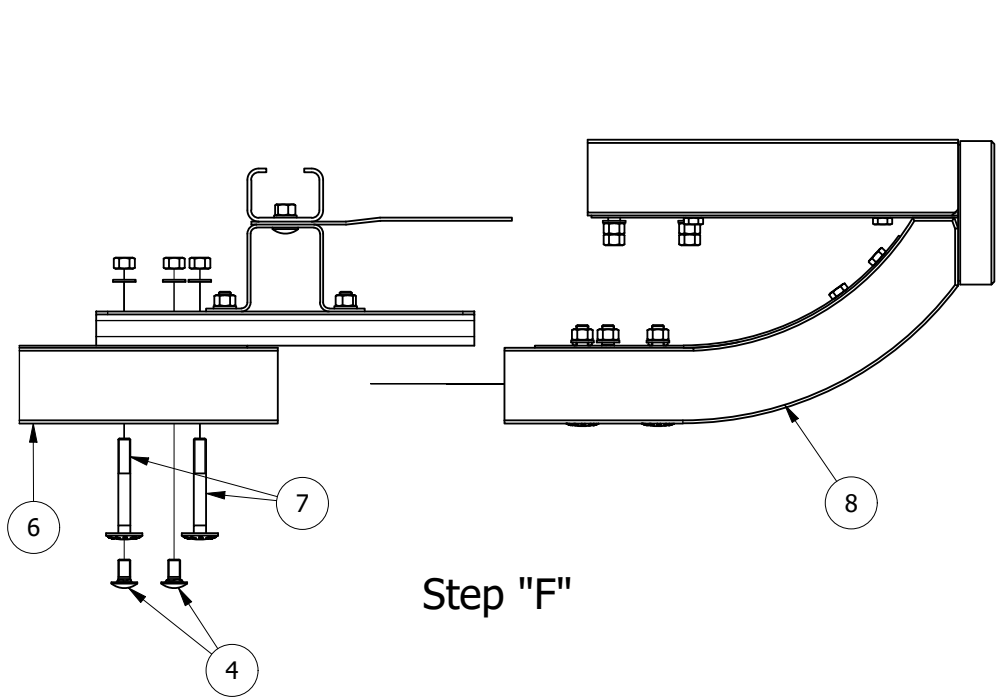

front view

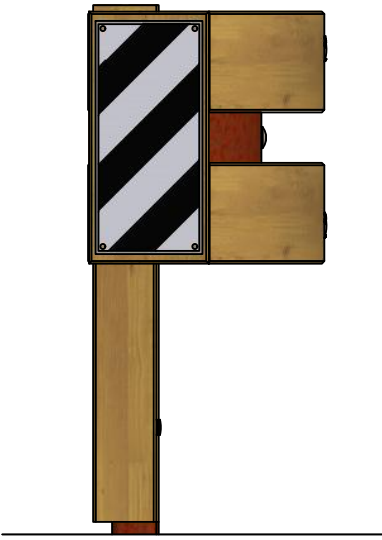

front view

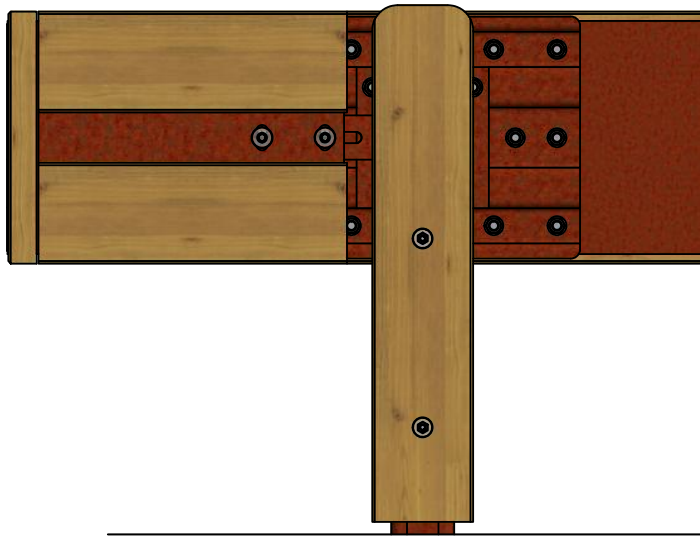

rear lateral view

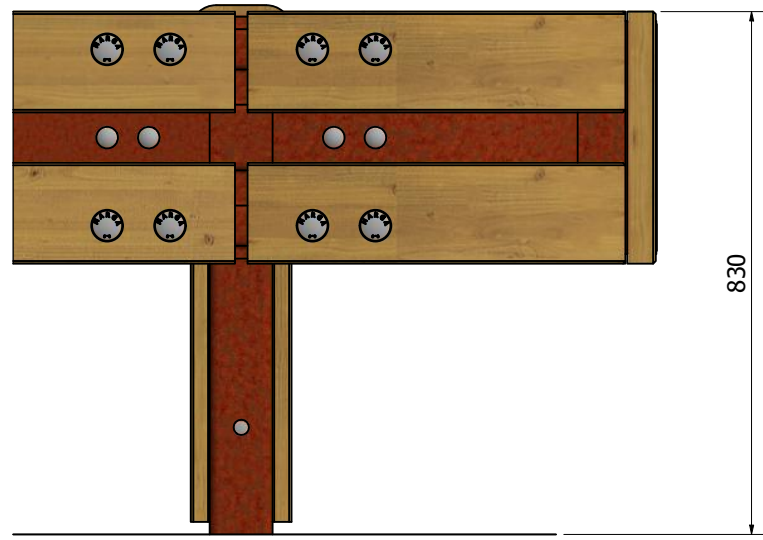

lateral view

Misure espresse in mm

Coppie di serraggio:

- Ref. 4 120 Nm
- Ref. 7 & 13 torque between 150 & 200 Nm
- Ref. 9 tighten with nut and locknut

The torque values must be checked with a calibrated torque wrench
NB Carry out the indicated dimensions with extreme accuracy

Component list	
Ref.	Item
1	"C" post
2	Blockout
3	Bracket
4	Bolts TT M16x30
5	Corrugated Splice plate
6	Protection rail
7	Bolts TTQST M16x125
8	T50 Terminal
9	Bolts TT M16x35
10	Singl post cover
11	Bolts TTQST M10x100
12	Wood screw 14x60 & M16 washer
13	Bolts TT M16x30

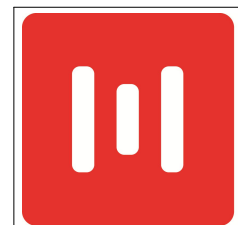

MARGARITELLI
ROAD SAFETY

Drawing IM 034-02	Issued 19/12/2022
Review 00	Date --/------

Object: Energy absorbing terminal T50 class - T50-01
 Tested for T50 Class in compliance with CEN/TS Terminals
 Assembly instructions